



# DIGITAL HOME THEATER SYSTEM HT-DL70D

**SAMSUNG ELECTRONICS CANADA, INC.**

**HEADQUARTERS**

7037 Financial Drive, Mississauga, Ontario, Canada L5N 6R3  
TEL: 1-905-542-3535  
[www.samsungcanada.com](http://www.samsungcanada.com)

**SERVICE DIVISION**

7037 Financial Drive, Mississauga, Ontario, Canada L5N 6R3  
1-800-SAMSUNG (1-800-726-7864)



## Instruction Manual

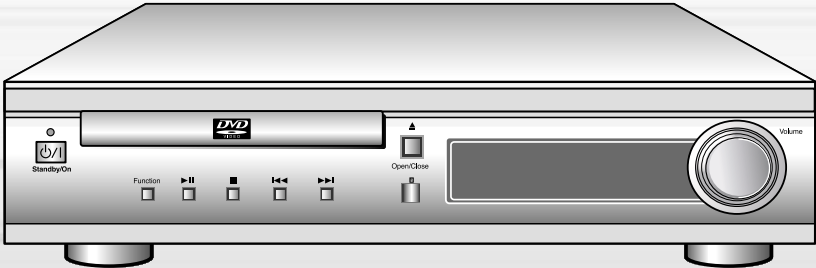

# Safety Warnings

GB

CLASS 1 LASER PRODUCT  
 KLASSE 1 LASER PRODUKT  
 LUOKAN 1 LASER LAITE  
 KLAS 1 LASER APPARAT  
 PRODUCTO LASER CLASE 1

CLASS 1 LASER PRODUCT

This Compact Disc player is classified as a CLASS 1 LASER product.

Use of controls, adjustments or performance of procedures other than those specified herein may result in hazardous radiation exposure.

**CAUTION-INVISIBLE LASER RADIATION WHEN OPEN AND INTERLOCKS DEFEATED, AVOID EXPOSURE TO BEAM.**

**CAUTION**  
 RISK OF ELECTRIC SHOCK.  
 DO NOT OPEN

CAUTION:  
 TO REDUCE THE RISK OF ELECTRIC SHOCK, DO NOT REMOVE REAR COVER. NO USER SERVICEABLE PARTS INSIDE. REFER SERVICING TO QUALIFIED SERVICE PERSONNEL.



This symbol indicates that dangerous voltage which can cause electric shock is present inside this unit.



This symbol alerts you to important operating and maintenance instructions accompanying the unit.

**WARNING:** To reduce the risk of fire or electric shock, do not expose this appliance to rain or moisture.

**CAUTION:** TO PREVENT ELECTRIC SHOCK, MATCH WIDE BLADE OF PLUG TO WIDE SLOT, FULLY INSERT.

# Precautions

GB

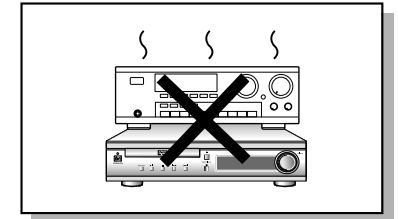
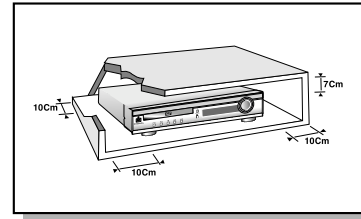

Ensure that the AC power supply in your house complies with the identification sticker located on the back of your player. Install your player horizontally, on a suitable base (furniture), with enough space around it for ventilation (3-4 inches). Make sure the ventilation slots are not covered. Do not stack anything on top of the player. Do not place the player on amplifiers or other equipment which may become hot. Before moving the player ensure the disc tray empty. This player is designed for continuous use. Switching off the DVD player to the stand-by mode does not disconnect the electrical supply. In order to disconnect the player completely from the power supply, remove the main plug from the wall outlet, especially when left unused for a long period of time.

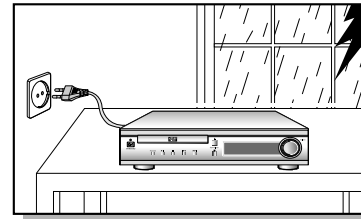

During thunderstorms, disconnect AC main plug from the wall outlet. Voltage peaks due to lightning could damage the unit.

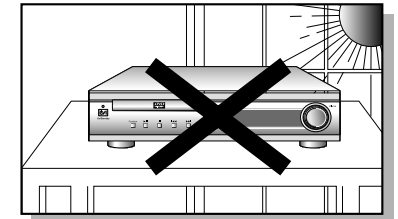

Do not expose the unit to direct sun radiation or other heat sources. This could lead to overheating and malfunction of the unit.

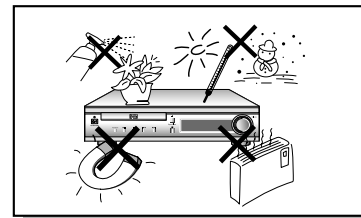

Protect the player from moisture (i.e. vases), and excess heat (e.g. fireplace) or equipment creating strong magnetic or electric fields (i.e. speakers...). Disconnect the power cable from the AC supply if the player malfunctions. Your player is not intended for industrial use. Use of this product is for personal use only. Condensation may occur if your player or disc has been stored in a cold atmosphere. If transporting the player during the winter, wait approximately 2 hours until the unit has reached room temperature before using.

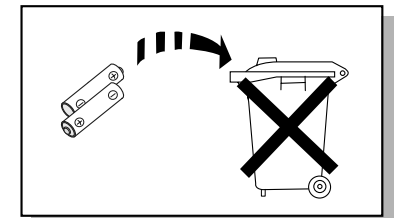

The battery used with this product contain chemicals that are harmful to the environment. Do not dispose of batteries in the general household trash.



# Contents

GB



**DVD (Digital Versatile Disc)** offers fantastic audio and video, thanks to Dolby Digital surround sound and MPEG-2 video compression technology. Now you can enjoy these realistic effects in the home, as if you were in a movie theater or concert hall.



DVD players and the discs are coded by region. These regional codes must match in order for the disc to play. If the codes do not match, the disc will not play. The Region Number for this player is given on the rear panel of the player. (Your DVD player will only play DVDs that are labeled with identical region codes.)

## Do not use the following types of disc!

- LD, CDG, CD-I, CD-ROM and DVD-ROM cannot be played on this player. If such discs are played, a "WRONG DISC FORMAT" message appears on the TV screen.
- DVD discs purchased abroad may not play on this player. If such discs are played, a "WRONG REGION CODE" message appears on the TV screen.

### Copy Protection

- Many DVD discs are encoded with copy protection. Because of this, you should only connect your DVD player directly to your TV, not to a VCR. Connecting to a VCR results in a distorted picture from copy-protected DVD discs.
- This product incorporates copyright protection technology that is protected by methods claims of certain U.S. patents and other intellectual property rights owned by Macrovision Corporation and other rights owners. Use of this copyright protection technology must be authorized by Macrovision Corporation, and is intended for home and other limited viewing uses only unless otherwise authorized by Macrovision Corporation. Reverse engineering or disassembly is prohibited.

Safety Warnings .....	1
Precautions .....	2
Description .....	5
Remote Control Unit .....	7
Connecting the Speakers .....	9
Connecting Video to TV .....	10
Connecting the FM and AM/MW Antennas .....	11
AUX Connections .....	12
Connecting your System to the Power Supply .....	13
Before Using the DVD Player .....	14
DVD Playback .....	15
Forward/Reverse Searching .....	17
Slow Playback/Checking the Remaining Time .....	18
Repeat Playback .....	19
Using Disc Menu/Title .....	20
Program Playback .....	21
Selecting the Audio Language/Subtitle Language .....	23
Various DVD Functions .....	24
•To enlarge an image .....	24
•Selecting the desired Screen Angle .....	24
•To move directly to a title, chapter, or time .....	24
MP3 Playback .....	25
System Setup .....	27
Setting up the Language Features .....	29
Activating Dynamic Range Compression .....	30
Speaker Setup .....	31
Creating Realistic Sound Fields .....	35
DSP/EQ Function .....	36
Power Sound Function .....	36
Listening to the Radio .....	37
Presetting stations .....	38
Sleep Function .....	39
Troubleshooting .....	40
Cautions on Handling and Storing Discs .....	42
Disc Type and Protection .....	43
Specifications .....	44

GB

# Description

## Front Panel

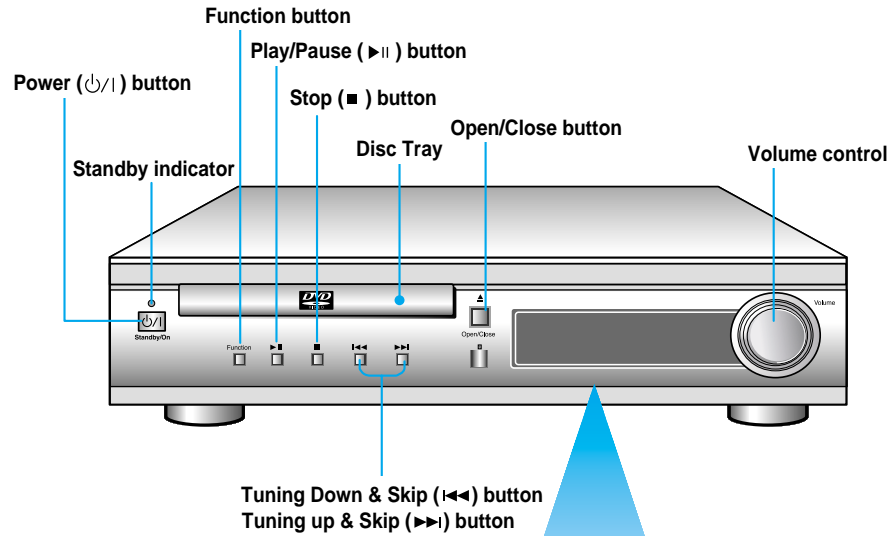

## Display

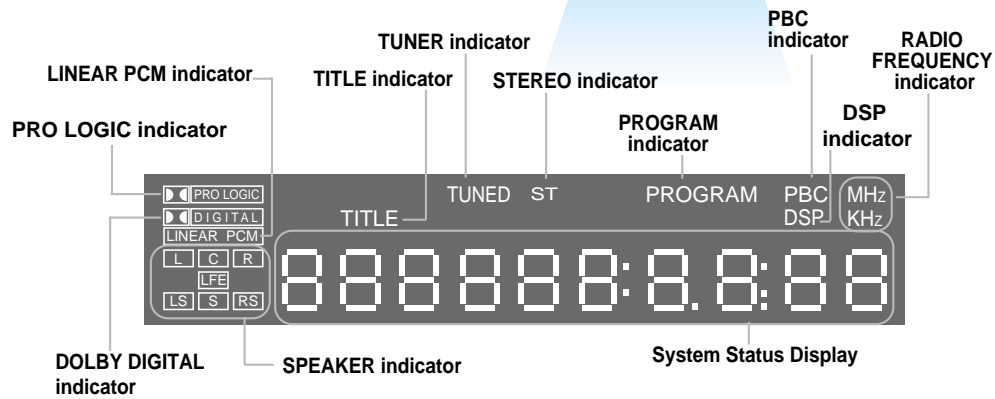

## Rear Panel

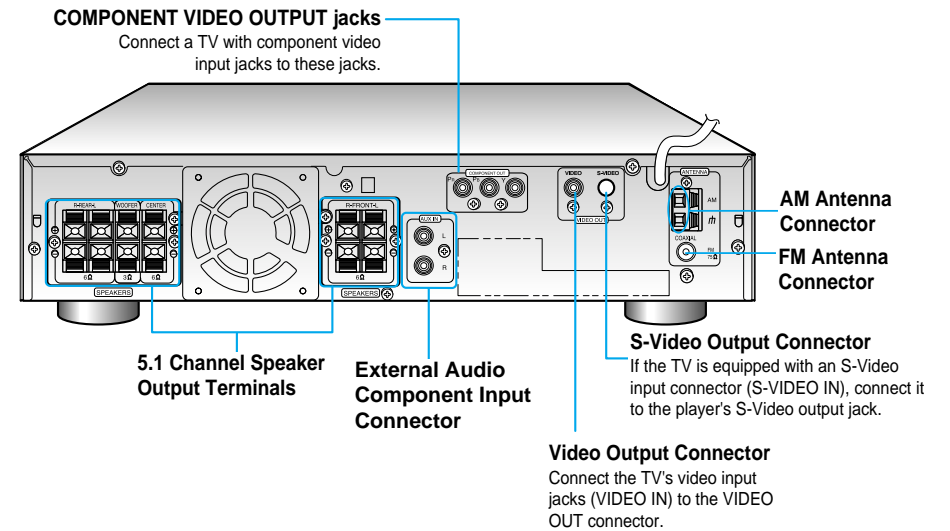

## Accessories

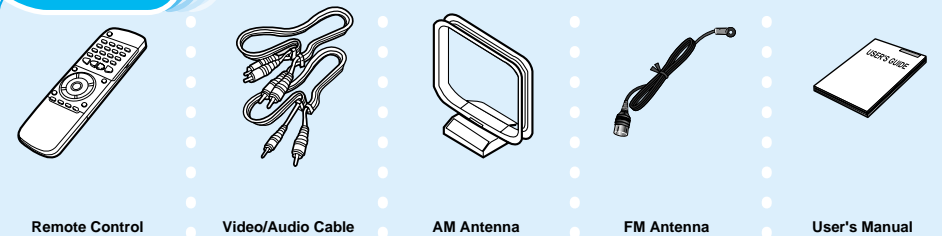

# Remote Control Unit



DVD POWER button

- DVD button
- TUNER button
- AUX button

- Title button
- Menu button
- Subtitle button
- Audio MO/ST(mono/stereo) button

- Display button
- Return button
- Go To button

Power Sound button

DSP/EQ button

To open the remote control cover, push the top of the cover, then slide downward.



- Open/Close button
- Step button
- Remain button
- Repeat (A->B) button
- Repeat button
- Zoom button
- Play/Pause button
- Stop button
- Tuning Preset/CD Skip button
- Tuning Up/Down/CD Search button
- Direction/Enter button
- Volume Control buttons  
Speaker output volume control
- Sleep button
- Mute button

Selection button

Slow button

Setup button

Angle button

Subwoofer Speaker button

D.R.C button

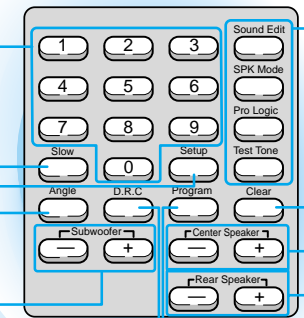

- Sound Edit button
- SPK Mode button
- Pro Logic button
- Test Tone button

- Clear button
- Center Speaker button
- Rear Speaker button
- Program button



## Insert Remote Batteries

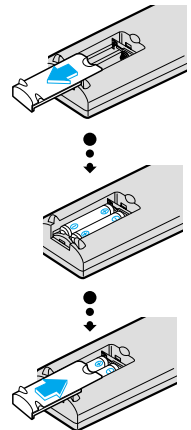

- 1 Remove the battery cover on the back of the remote by pressing down and sliding the cover in the direction of the arrow.
- 2 Insert two 1.5V AAA batteries, paying attention to the correct polarities (+ and -).
- 3 Replace the battery cover.



- Follow these precautions to avoid leaking or cracking cells:
- Place batteries in the remote control so they match the polarity: (+) to (+) and (-) to (-).
  - Use the correct type of batteries. Batteries that look similar may differ in voltage.
  - Always replace both batteries at the same time.
  - Do not expose batteries to heat or flame.

## Range of Operation of the Remote Control

The remote control can be used up to approximately 23 feet/7 meters in a straight line. It can also be operated at a horizontal angle of up to 30° from the remote control sensor.

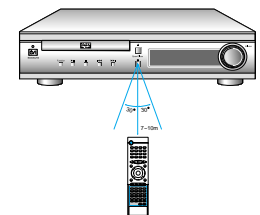

# Connecting the Speakers

GB

- Connect the satellite speakers, center speaker, and subwoofer to the terminals on the rear panel using speaker cords supplied.
- Insert the end of the speaker cord into the terminal. Match the polarity (colors): Red (+) to red (+) and black (-) to black (-).

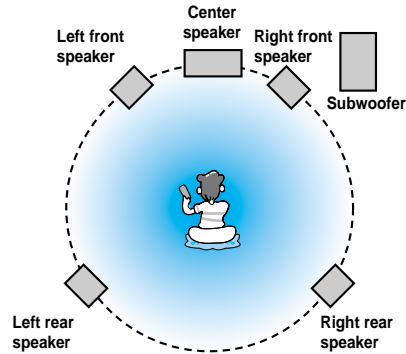

**1** Press and hold the terminal tab.

**2** Insert the speaker cord.

**3** Release your finger.

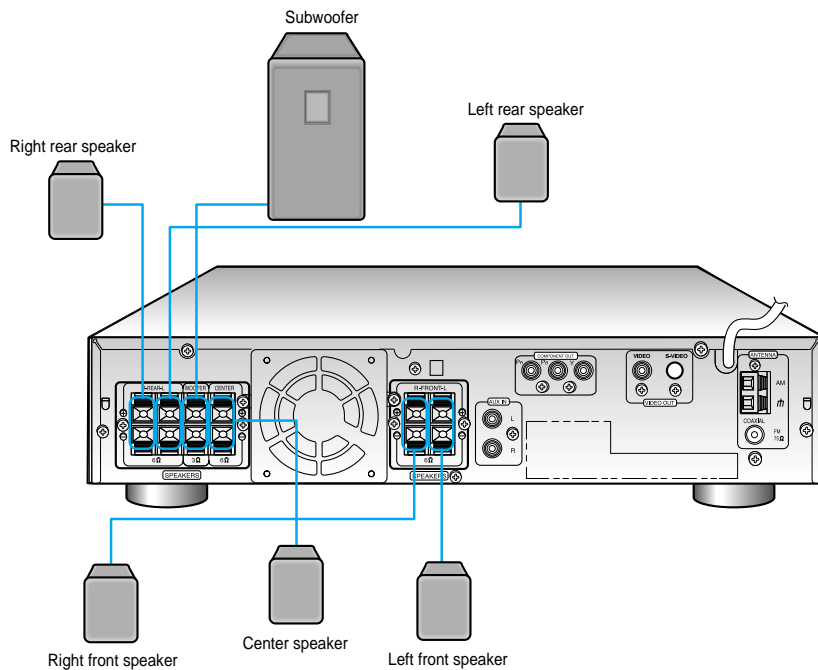
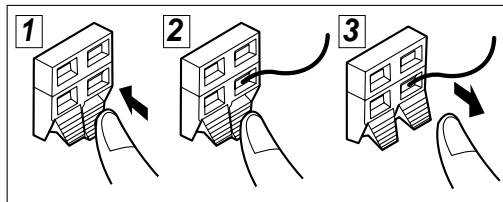

**Note**

• for in-depth information about adjusting the delay time, see "Speaker Settings" on page 32.

# Connecting Video to TV

GB

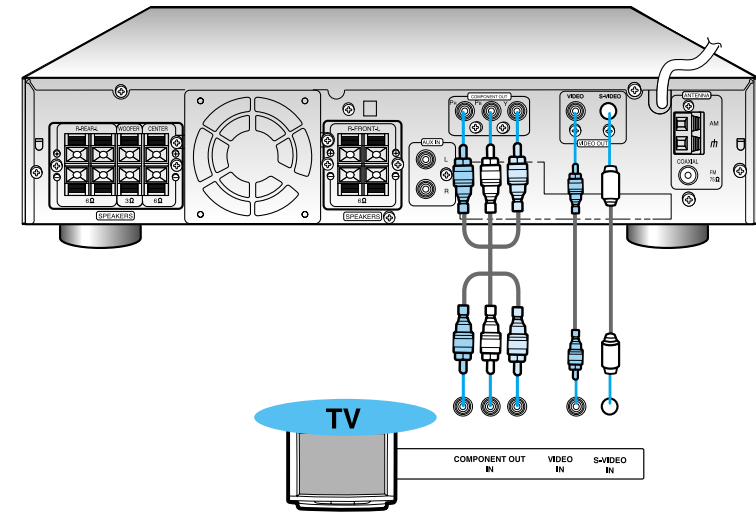

## Composite Video (Good Quality)

Connect the supplied video cable from the VIDEO OUT jack on the back panel of the system to the VIDEO IN jack on your television.

## S-Video (Better Quality)

If your television is equipped with an S-Video input, connect an S-Video cable (not supplied) from the S-VIDEO OUT jack on the back panel of the system to the S-VIDEO IN jack on your television.

## Component Video (Best Quality)

If your television is equipped with Component Video inputs, connect a component video cable (not supplied) from the Pr, Pb and Y jacks on the back panel of the system to the corresponding jacks on your television.

# Connecting the FM and AM(MW/LW) Antennas

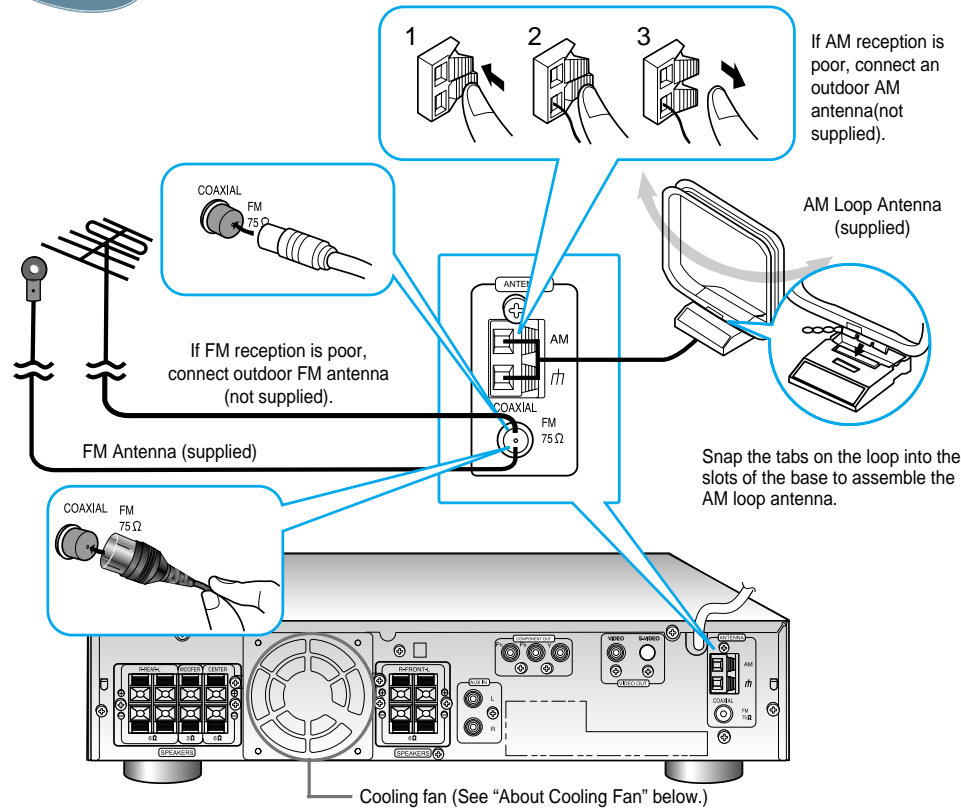

## FM antenna connection

1. Connect the FM antenna supplied to the FM 75Ω COAXIAL terminal.
2. Slowly move the antenna wire around until you find a location where reception is good, then fasten it to a wall or other rigid surface.

- If reception is poor, connect an outdoor antenna. Before attaching a 75Ω coaxial cable (with a standard type connector), disconnect the supplied FM antenna.

### (About the cooling fan)

A cooling fan is mounted on the rear panel of the center unit to prevent abnormal temperature inside the center unit, thus assuring normal operation. The cooling fan automatically starts rotating to supply external cool air to the inside of the center unit when the internal temperature exceeds the specified limit.

## AM/MW antenna connection

1. Connect the AM loop antenna supplied to the AM and  $\pi$  terminals.
2. If reception is poor, connect an outdoor single vinyl-covered wire to the AM terminal. (Keep the AM loop antenna connected).

### For safety, observe the following carefully.

- Make sure there is good ventilation around the center unit. Poor ventilation could overheat and damage the center unit.
- DO NOT block the cooling fan and the ventilation openings or holes. (If they are blocked by a newspaper or cloth, etc., the heat may not be able to escape.)

# AUX Connections

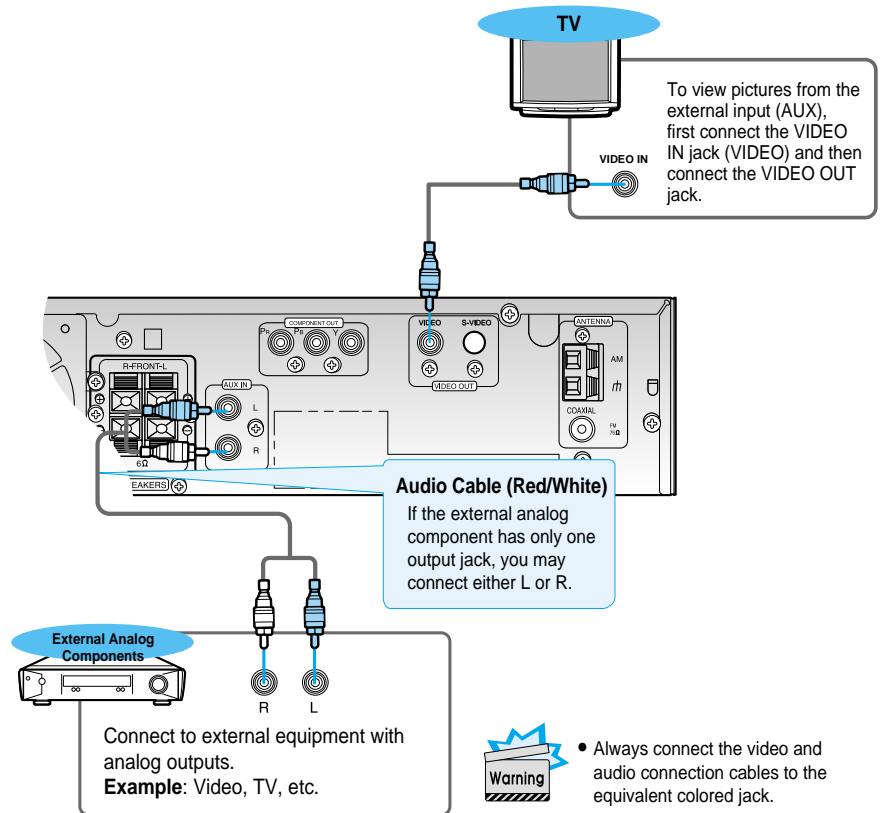

## Making Analog Input Selection

- Remote Control → Press the **AUX** button and select AUX IN.
- Main Unit → Press the **Function** button and select AUX IN.



## Connecting your System to the Power Supply

GB

### The AC plug must be plugged into an appropriate socket.

Before plugging your system into an AC outlet, you must check the voltage.

1. Plug the AC Cord on the rear of the system into an appropriate outlet.
2. Press the On/Standby button to switch your DVD Player system on.

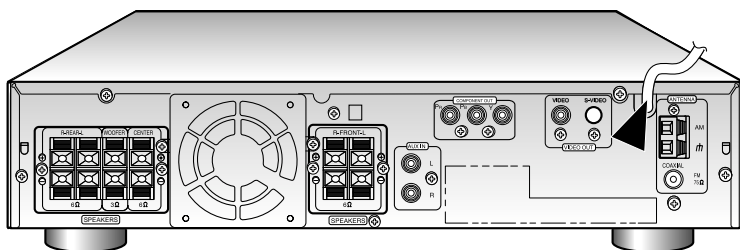

## Before Using the DVD Player

Your DVD player is capable of playing DVD, VCD, and CD discs. User instructions may vary depending on the type of disc. Read the instructions carefully before use.

1

Preparations before use

Turn on the power to your DVD player and TV.



2

Select a video mode by pressing the TV/VIDEO button.

3

Press the DVD button to select the DVD input function.



### Note

- The "WAIT" message that appears on the display for about seven to eight seconds when turning on the power or selecting a DVD function indicates a stabilization period for optimizing the condition of your DVD player. While the message is being displayed, other buttons remain inactive.
- When the power is not turned on, press down the Stop (■) button on the main unit for over 5 seconds. The product will be initialized to its optimum state.
- Certain operational features such as the Speaker mode, Test tone, Volume, etc. will not be displayed on the TV screen.

### TV Broadcast System

- This device is designed to work with the NTSC video format.
- For normal playback, the video format a DVD disc is recorded in must coincide with your TV's video format.



# DVD Playback

GB

- 1**

Press the **Open/Close** (▲) button to open the disc tray.

  - The button is located on the Front Panel of the player (not on the remote).
- 2**

Insert a disc.

  - Place a disc gently into the tray with the disc's label facing up.
- 3**

Press the **Open/Close** (▲) button again to close the disc tray.

  - Playback starts automatically.

## Using the On-Screen Display

Press the **Display** button on the remote.

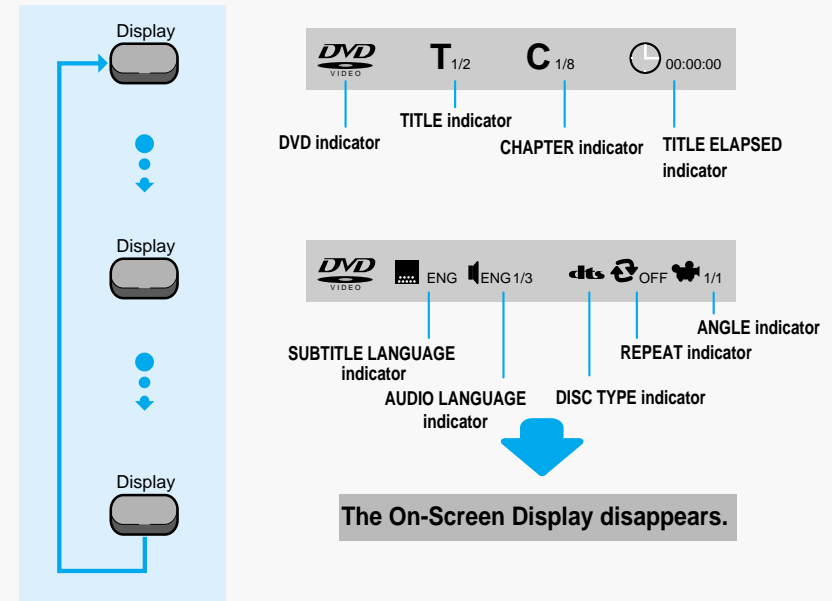

GB

### Pausing Playback



Press the **Play/Pause** (▶||) button during playback.

- To resume, press the Play/Pause (▶||) button again.

**Note**

- Depending on the disc, the initial disc information screen may look different from disc to disc.
- When playing a DVD containing MPEG format, video may not be reproduced correctly and you may get picture distortion.

### Stopping Playback



Press the **Stop** (■) button during playback.

- During playback, when the Stop (■) button is pressed, the position is stored in the memory, and ■ STOP is shown on the display. When the Play/Pause (▶||) button or Return button is pressed subsequently, playback resumes from the position at which it was stopped.
- If the Stop (■) button is pressed a second time, the 'resume play' memory function is canceled, and ■ STOP is shown on the display. When the Play/Pause (▶||) button is pressed, playback starts from the beginning.

**What is a Title?**

A movie contained in a DVD disc.

**What is a Chapter?**

Each Title on a DVD disc is divided into several smaller sections called "chapters".

### Turning the sound off temporarily?



Press the **Mute** button during playback.

- This operation may be useful when you need to greet guests or answer the telephone.

**Note**

If the player is left for more than 3 minutes in pause mode, it will stop.

# Forward/Reverse Searching

During playback, you can search quickly through a chapter or track for a specific scene or tune.

## Multi-Speed Playback

Press the **◀◀** and **▶▶** button.

Each time the **◀◀** button is pressed



Each time the **▶▶** button is pressed

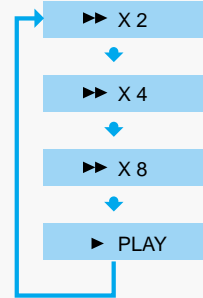

## Skipping through a Chapter

Press the **◀◀▶▶** button.

- Each time the button is pressed during playback, it moves to the next or previous chapter and plays it.

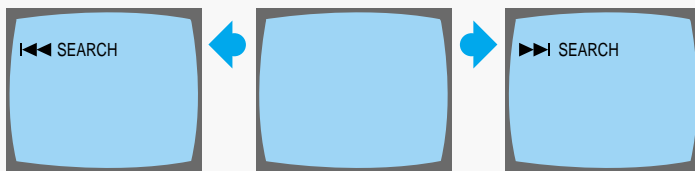

## Playing Frame by Frame

Press the **Step** button.

- The picture moves forward one frame each time the button is pressed.

**Note**

No sound is heard during high-speed playback, slow playback, and step motion.

# Slow Playback/Checking the Remaining Time

## Playing Slowly

Press the **Slow** button.

Each time the **Slow** button is pressed

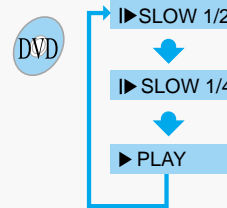

The slow playback speed changes and the selections (1/2X, 1/4X, 1/8X, 1/16X and normal play) are repeated.

## Checking the Remaining Time

Press the **Remain** button.

- For checking the total and remaining time of a title or chapter being played.

Each time the **Remain** button is pressed

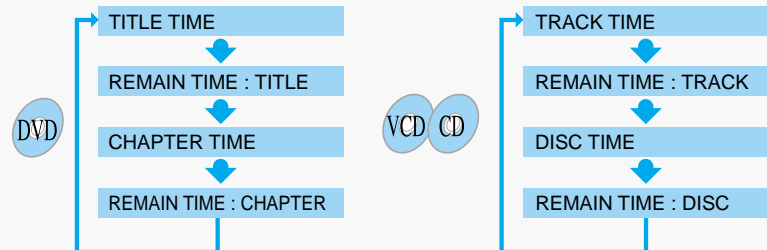

# Repeat Playback

Repeat playback allows you to repeat a chapter, title, or track.

## Playing Repeatedly

Press the Repeat button.

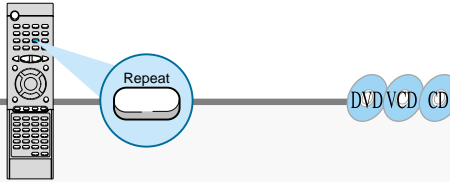

Each time the Repeat button is pressed

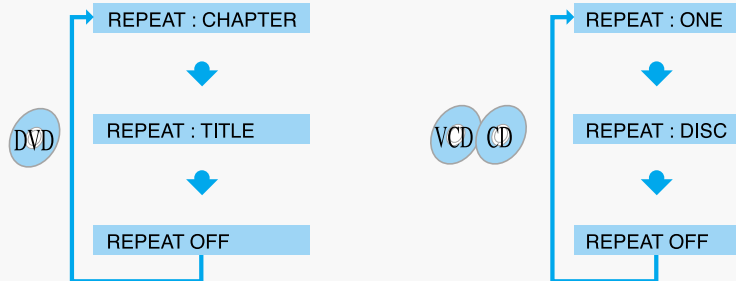

### Note

- Repeat playback operation is not possible with version 2.0 VCD discs if PBC is turned on. To operate this feature, press the MENU button, and then select "PBC OFF".

## A↔B Repeat Playback

- Press the **Repeat A↔B** button at the beginning (A) of the segment you want to review.
- Press the **Repeat A↔B** button again at the end (B) of the segment you want to review.
  - The segment will begin repeating.

### To return to normal playback

Press the Repeat A↔B button again.

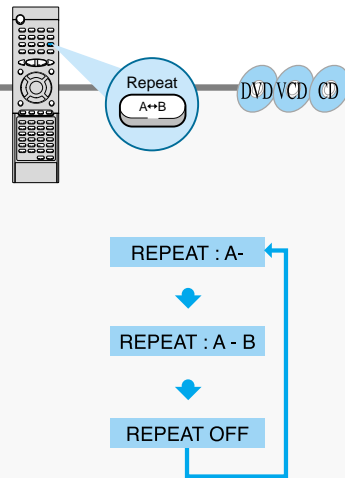

# Using Disc Menu/Title

## To Select the Disc Menu

You can use the menus for the audio language, subtitle language, profile, etc. DVD menu contents differ from disc to disc.

1

Press the **Menu** button during playback.

2

Use the **Up/Down** (▲ / ▼) or **Left/Right** (◀ / ▶) button to access the different features.

3

Press the **Enter** button.

- The Menu Screen appears.
- When playing VCD version 2.0, you can operate it using PBC On/Off function.

- The selected item will play.

## Using the Title Menu

For DVDs containing multiple titles, you can view the title of each movie. Depending on the disc, this function may either not work at all, or may work differently.

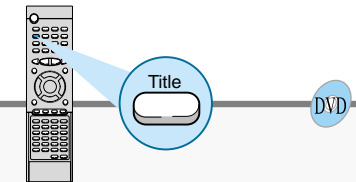

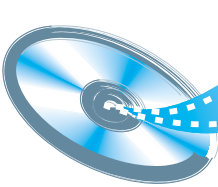

# Program Playback

Use this function to program chapters or tracks in a particular order.



## To Program Tracks in a particular order

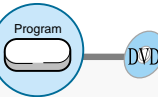

### 1

Press the **Program** button.

### 2

Press the **Enter** button, then use the **Number** buttons to select the desired title.

### 3

Press the **Enter** button, then use the **Number** buttons to select the desired chapter.

- You can also use the **Left/Right** (◀/▶/▲/▼) button.

- You can also use the **Left/Right** (◀/▶/▲/▼) button.

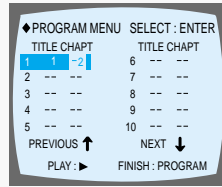
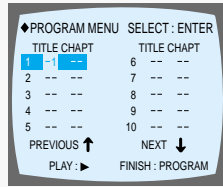
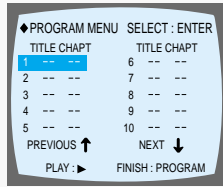

### 4

Press the **Enter** button.

### 5

At this time, you can continue programming if you want to.

- The selected track number is programmed and the cursor moves to the next number.

- When programming more than 10 tracks, select **NEXT**↓ and then press the **Enter** button. The program selection screen where you can program up to 10 additional tracks appears.

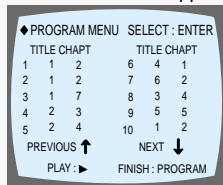
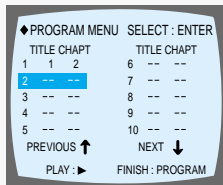

## To Playback the Tracks in Programmed Order



Press the **Play/Pause** (▶||) button.

## To Leave the Programming Mode

••• Press either the **Program** or **Stop** (■) button.



## To Change the Program



### 1

Press the **Up/Down** (▲/▼) button to select the track number to be changed.

### 2

Press the **Enter** button to select the title or chapter to be changed.

### 3

Press the **Clear** button and then press the **Number** buttons.

- The cursor moves to the next number when the **Enter** button is pressed again.

- You can also use the **Left/Right** (◀/▶) button.

### 4

Press the **Enter** button.

### 5

Repeat steps 1-4 above to change the program.

- The cursor moves to the number below.

## To delete the entire Program

- Press the **Stop** (■) button twice during playback.
- Press the **Stop** (■) button once when in the Stop mode.
- Press the **Open/Close** (▲) button on the main unit. The disc tray will open and then close. The program will then be deleted.

When you have entered a wrong number



Press the **Clear** button.

- When you want to delete a selection during programming, select the track (or chapter, or title) to be deleted and then press the **Clear** button.



- You can program or change particular tracks for VCD or CD discs in the same manner.
- Depending on the disc, the PROGRAM function may not work.

# Selecting the Audio Language/Subtitle Language

## Selecting the Audio Language

Press the Audio button.

- Depending on the number of languages recorded on a DVD disc, a different audio language (ENGLISH, SPANISH, FRENCH, etc.) is selected each time the button is pressed.

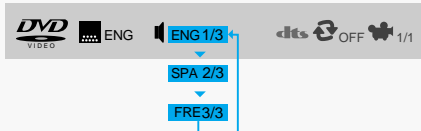

- Note**
- Depending on the disc, DTS or DIGITAL PRO LOGIC can be selected.

## Selecting the Subtitle Language

Press the Subtitle button.

- Depending on the number of languages recorded on a DVD disc, a different subtitle language (ENGLISH, SPANISH, FRENCH etc.) is selected each time the button is pressed.
- To make the subtitles disappear, select "OFF".



- Note**
- If the word INVALID appears on the TV screen while buttons are being operated, that operation is not possible with that particular disc.
  - Depending on the disc, the audio or subtitle language function may not work.

# Various DVD Functions

## To enlarge an image

Press the Zoom button.

- Images can be enlarged 2x and 4x.
- During DVD playback, press the **Zoom** button to zoom in 2X/4X/normal, in that order.
- Press ◀/▶/▲/▼ to move the enlarged portion you want to watch.

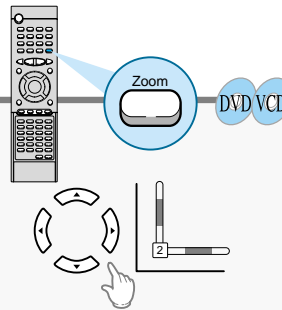

**Note**

- Only 2X zoom operation is possible during VCD playback.

## Selecting the desired Screen Angle

Press the Angle button.

- This function only works with discs on which multiple angles have been recorded.
- During playback, press the **Angle** button to select the desired angle in 1/3, 2/3, 3/3, normal, in that order.

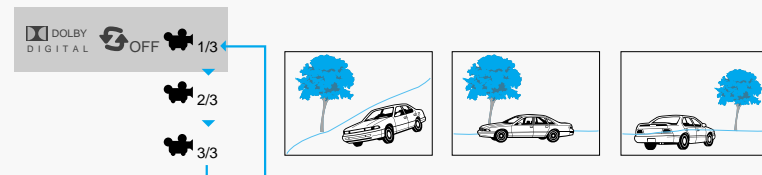

## To move directly to a title, chapter, or time

1 Press the Go To button.

2 Press Number(0~9) buttons or the Left/Right (◀/▶) button.

- Each time the button is pressed, it repeats as shown below.
- Each time the buttons are pressed the desired scene is located and then played.
- Depending on the disc, the Title function may not work.

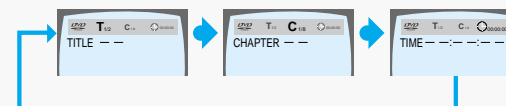

# MP3 Playback

This system has a built-in MP3 decoder.  
You can play back MP3 tracks (files) recorded on CD-Rs, CD-RWs, and CD-ROMs.

## Starting Playback

- It is recommended you turn on your TV when playing back an MP3 disc.

1

Press the **Open/Close** (▲) button to load a disc.

2

Press the **Play/Pause** (▶||) button.

- After detecting the disc, playback starts.
- The on-screen bar and the contents recorded on the MP3 disc will be shown on the TV if it is turned on.

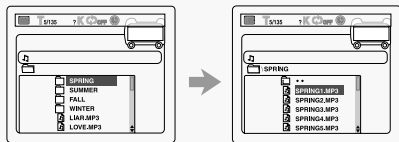

On-screen bar goes off.

- Disc type**  
DVD VCD CD MP3
- Current track (file) and total number of the tracks on the disc**  
• Ex.: 1st track is playing out of 35 tracks recorded.
- Bit rate**  
• Ex.: Bit rate used for recording the loaded disc is 128 Kbps. (See below)
- Repeat mode indicator**  
• Ex.: When repeat mode is turned off. See page 28 for more details.
- Elapsed playing time and the total playing time of the current track**
- Sound indication**  
• Indicates sound input level. (Only appears during playback.)

## To stop during playback

Press the **Stop** (■) button.

### What is MP3?

MP3 is an abbreviation of Motion Picture Experts Group (or MPEG) Audio Layer 3. MP3 is simply a file format with a data compression ratio of 1:10 (128 Kbps\*). That means, by using MP3 format, one CD-R or CD-RW can contain 10 times as much data volume as a regular CD can.

\*Bit rate is the average number of bits that one second of audio data will consume. The measuring unit used is Kbps (1000 bits per second).

To obtain better audio quality, choose a higher bit rate. The most popular bit rate for encoding (recording) is 128 Kbps.

### MP3 File Compatibility

- This system can only read MP3 files that are recorded in the format that is compliant with ISO 9660 Level 1 or Level 2.
- The system can read or play MP3 files only with the extension code —“.mp3”.
- ID3\*tags cannot be shown on the display.
- \*An MP3 file can contain file information called “ID3 Tag” where its album name, performer, rack title, etc. are recorded.

## Operations Using the On-Screen Display

Turn on your TV when playing back an MP3 disc.

When the loaded MP3 disc is recognized, the following on-screen display appears on the TV screen. (The contents of this on-screen display vary according to the disc — the way MP3 tracks were recorded on the disc.)

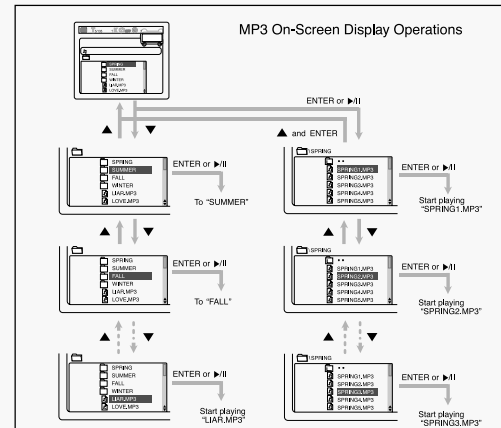

Button	To do
ENTER, ▶	Start playback or go into a directory.
▲/▼	Select a track or directory.

### CD-R/RW playback compatibility

- Your DVD player can also play CD-R and CD-RW discs recorded in digital audio format. When recording your own CD-R or CD-RW discs, make sure that the recording session is properly terminated, or they will not be playable. (Depending on disc properties and recording quality, some CD-R/RWs may not be playable.)
- CD-RW has a lower reflection rate than CD-R media and consequently it will take a longer to read CD-R discs.
- CD-RW discs recorded at high speed tend to be difficult for the DVD player to read. If the recording speed for the CD-RW disc is not predetermined, write it at low speed.

## Repeating Playback

On an MP3 disc, Repeat A↔B cannot be used. You can enjoy only repeat play.

### Press the REPEAT button.

The indication corresponding to the selected mode appears on the TV screen.

- Each time you press the button, repeat mode changes as follows:

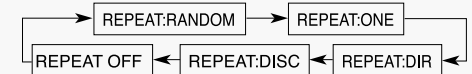

#### REPEAT:RANDOM

: All tracks recorded on the disc will be played once in random order.

#### REPEAT:ONE

: Current track will be repeated.

#### REPEAT:DIR

: Tracks in the current directory will be repeated.

#### REPEAT:DISC

: All tracks on the disc will be repeated.

#### REPEAT OFF

: Repeat play is canceled. (Normal play is resumed.)

# System Setup

You can use the DVD player's Setup function to select the TV screen ratio, rating limit, or digital output mode.

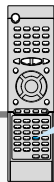

DVD

## To Set up the System

1

From the stop mode, press the **Setup** button.

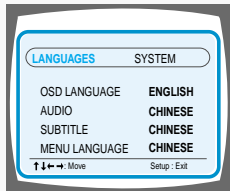

2

Press the **Left/Right** ( ◀ / ▶ ) button to select the system.

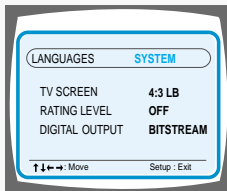

3

Press the **Up/Down** ( ▲ / ▼ ) button to select the desired item.

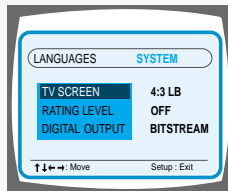

4

Press the **Enter** button or **Right** ( ▶ ) button.

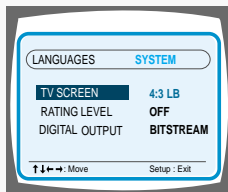

5

Press the **Up/Down** ( ▲ / ▼ ) button to select the desired sub-item and then press the **Enter** button.

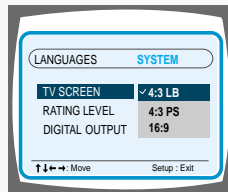

## To End the System Setup



- Press the **Setup** button again.

## TV SCREEN(TV SCREEN RATIO)

Select when you want to watch a 16:9 screen ratio DVD movie on a TV with a 4:3 ratio screen.

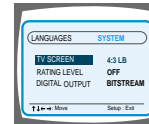

- 4:3LB** You can see the full 16:9 picture, but black bars will appear at the top and bottom of the screen.
- 4:3PS** You can only view the central portion of the 16:9 screen.
- 16:9** You can view in widescreen, but the top and bottom of the picture will be cut off.

- If the movie is recorded in 4:3 ratio, you cannot view the full 16:9 picture with the above functions.

## RATING LEVEL

The Rating Level function works in conjunction with DVDs which have been assigned a rating, to help control the type of DVD that your family watches.

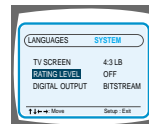

1. Select **RATING LEVEL**, then press the **Enter** button.

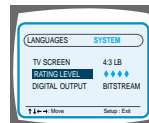

2. Use the number(0-9) buttons to input a 4-digit password.

- The player's password is set to "7890" by default.

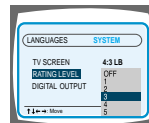

3. Use the **Up/Down** ( ▲ / ▼ ) button to select either **RATING LEVEL** or **NEW PASSWORD**, and then press the **Enter** button.

- There are up to 8 rating levels on a disc.
- If LEVEL 6 is selected, a disc which contains rating LEVEL 7 and above cannot be played.
- If you select **NEW PASSWORD**, the screen changes and enables you to enter the new password.

### When the rating level password has been forgotten

While the player is in the stop mode, hold the **Stop** ( ■ ) button down on the main unit for more than 5 seconds.

- "INITIAL" appears on the display and all default settings will return to Factory Preset.
- Press the **Power** button.



# Setting up the Language Features

Using the DVD player's Setup function, you can customize the Menu Language, Subtitle Language, and Disc Menu Language.

## To set up the language feature

1

Press the **Setup** button from the stop mode.

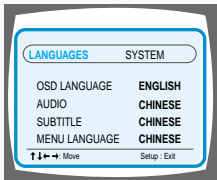

2

Press the **Up/Down** (▲/▼) button to select the desired item.

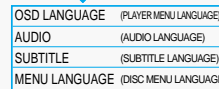
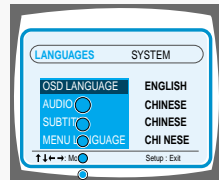

3

Press the **Enter** button or **Right** (▶) button.

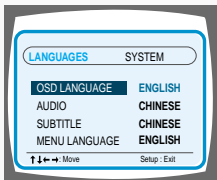

4

Press the **Up/Down** (▲/▼) button to select the desired language and then press the **Enter** button.

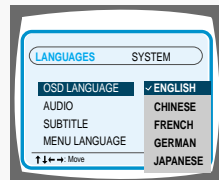

## To End the Language Features Setup

- Press the **Setup** button again.

Setup

# Activating Dynamic Range Compression

## Activating Dynamic Range Compression

You can enjoy a powerful sound even at a low volume level by compressing the dynamic range (difference between the maximum and minimum sounds).

### From the remote control ONLY:

#### Press the D.R.C button.

- Each time you press the button, the dynamic range compression mode alternates between on and off. Select "D.R.C.ON" while watching the DVD at night. (You can obtain a powerful sound at a low volume.)
- This function takes effect only when Dolby Digital or DTS Digital Surround is activated.



# Speaker Setup

## Setting up Speaker Mode and Delay Time

Press the **SPK Mode** button.

- Each time the button is pressed, a different mode selection is displayed on the front panel display as shown below.

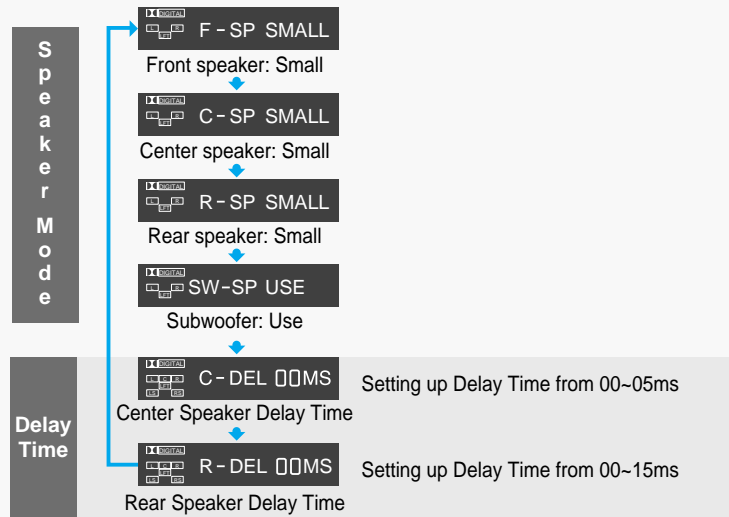

- SMALL: When this setting is selected, low frequencies of below 200 Hz are assigned to the subwoofer only.
- USE: Select when using speakers.

### Note

- The display changes depending on the current audio output mode (DSP, PRO LOGIC, 3-STEREO, STEREO, etc.).
- When in the speaker mode, the center and rear speakers and the subwoofer cannot be selected.

## To set the delay time

- When 5.1 Channel Surround Sound is played, you can enjoy the best sound if the distance between you and each speaker is the same. You can set Delay Time in the Center/Rear Speaker to customize the sound to the acoustics of your room.
- Setting Center Speaker**  
If the distance of  $D_c$  is equal to or longer than the distance of  $D_f$  in the figure, set the mode as 0ms. Otherwise, change the setting according to the table on the table.
- Setting Rear Speakers**  
If the distance of  $D_f$  is equal to the distance of  $D_s$  in the figure, set the mode as 0ms. Otherwise, change the setting according to the table.

(A)= $D_f - D_c$

Distance of (A)	Value
50	1.3ms
100	2.6ms
150	3.9ms
200	5.3ms

(B)= $D_f - D_s$

Distance of (B)	Value
200	5.3ms
400	10.6ms
600	15.9ms

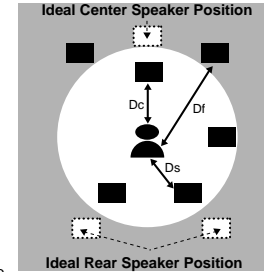

Arrange all speakers within a circle as shown in the figure.

- $D_c$ : Distance from center speaker to listening position
- $D_f$ : Distance from front speakers to listening position
- $D_s$ : Distance from rear speakers to listening position

## Speaker Setting Methods

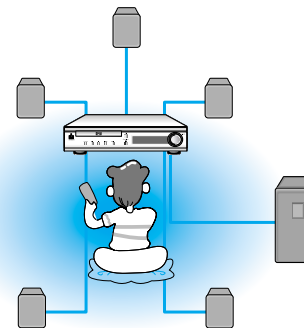

### Front Speakers

Set the front speakers so that their tweeters (high-range) are aligned at about ear level and at a horizontal angle of 45° to the prime listening position.

### Center Speaker

Ideally the center speaker should be positioned with its top surface flush with the front speakers. However, you may place the speaker either on top or near the bottom of your TV set.

### Rear Speakers

Set the rear speakers further back, parallel to the walls, at 60 to 90 centimeters (2 to 3 feet) above prime listening position ear level.

If the space behind the listening position is insufficient (i.e., too close to the wall), place the rear speakers facing each other on either side.

### Subwoofer Speaker

Place the subwoofer at any convenient location within the vicinity of the listening position.

# Speaker Setup

## To set up Speaker Balance

1

Press the **Sound Edit** button.

- Each time the button is pressed the selection switches as shown below.

### Example: 5.1CH Sound Setup

OFF, range of -6 ~ 0

Front Speakers: L level, R level

OFF, range of -6 ~ 0

Rear Speakers: L level, R level

range of -6 ~ -00 ~ +6

Center Speaker

range of -6 ~ -00 ~ +6

Rear Speakers

range of -6 ~ -00 ~ +6

Subwoofer Speaker

- You can adjust various settings by using their corresponding buttons on the remote control unit.

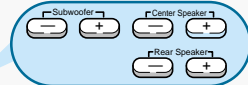

## Speaker Setting Methods

Press the **Test Tone** button.

- The test signal will be sent to the Left Front, Center, Right Front, Right Rear, Left Rear in that order.

To End the Speaker Setup

- Press the **Test Tone** button again.

**Note**

While in DSP or PRO LOGIC mode, TEST TONE may operate differently for VCDs or CDs.

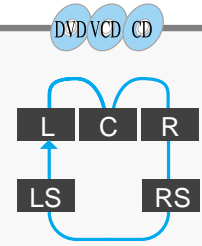

## Selecting Dolby Pro Logic

Press the **Pro Logic** button.

Converts Dolby Surround encoded 2-channel sound (e.g., program material received by Stereo VCR could be Dolby Surround encoded 2-channel material that can be decoded into 4-channel sound using the Dolby Pro Logic mode). Pro Logic mode can also be enjoyed when in DVD mode or when playing Dolby Digital or PCM material that is Dolby Surround encoded.

1

Press the **Function Selection** button to select the desired function.

- Select from FM, AM, DVD and AUX IN.

2

Press the **Pro Logic** button.

- Each time the Pro Logic button is pressed

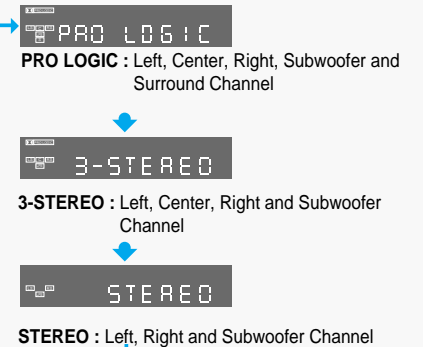

**Note**

The display changes depending on the current audio output mode (DSP, PRO LOGIC, 3-STEREO, STEREO, etc.).

# Creating Realistic Sound Fields

You can use the following surround to reproduce a realistic sound field.

- Digital Multichannel Surround —Dolby Digital and DTS Digital Surround
- Dolby Pro Logic

## Dolby Digital and DTS Digital Surround

To enjoy surround effectively, all the speakers need to be connected and activated.

### Dolby Digital

Used to reproduce multichannel sound tracks of the software encoded with Dolby Digital (  ).

**Dolby Digital** encoding method (discrete 5.1 channel digital audio format) records and digitally compresses the left front channel, right front channel, center channel, left rear channel, right rear channel, and LFE channel signals (total 6 channels, but LFE channel is counted as 0.1 channel. Therefore, LFE is called the 5.1 channel).

In addition, Dolby Digital enables stereo rear sounds, and sets the cutoff frequency of the rear treble at 20 kHz, compared to 7 kHz for Dolby Pro Logic. These facts result in better sound quality than Dolby Pro Logic.

When the system detects Dolby Digital signals, the DOLBY DIGITAL indicator lights up on the display.

### DTS Digital Surround

Used to reproduce multichannel sound tracks of the software encoded with DTS Digital Surround (  ).

**DTS Digital Surround** is another discrete 5.1 channel digital audio format available on CD, LD, and DVD software.

Compared to Dolby Digital, audio compression rate is relatively low.

This fact allows DTS Digital Surround format to add breadth and depth to the reproduced sounds. As a result, DTS Digital Surround features natural, solid and clear sound.

When the system detects DTS Digital Surround signals, the DTS indicator lights up on the display.

## Dolby Surround

Used to reproduce sound tracks of the VCR tapes encoded with Dolby Surround (  ).

This is only used for the sound sources coming through the AUX IN jacks.

### Dolby Pro Logic and Dolby 3 Stereo

**Dolby Surround** encoding format records the left front channel, right front channel, center channel, and rear channel signals (total 4 channels) into 2 channels.

The **Dolby Pro Logic** decoder built in this system decodes these 2 channel signals into original 4 channel signals — matrix-based multichannel reproduction, and allows you to enjoy a realistic stereo sound in your listening room.

When one of Dolby Surround modes is selected, the PRO LOGIC indicator lights up on the display.

### \* Sources recorded in Dolby Surround

These are sources in which three or more channels of surround have been recorded as two channels of signals using Dolby Surround encoding technology.

Dolby Surround is used for the sound tracks of movies recorded on DVDs, LDs and video cassettes to be played on stereo VCRs, as well as for the stereo broadcast signals of FM radio, TV, satellite broadcasts and cable TV.

Decoding these signals with Dolby Pro Logic makes it possible to achieve multi-channel surround playback.

The signals can also be played on ordinary stereo equipment, in which case they provide normal stereo sound.

Manufactured under license from Dolby Laboratories. "Dolby," "Pro Logic," and the double-D symbol are trademarks of Dolby Laboratories. Confidential Unpublished Works. ©1992–1997 Dolby Laboratories, Inc. All rights reserved.

Manufactured under license from Digital Theater Systems, Inc. US Pat. No. 5,451,942 and other world-wide patents issued and pending. "DTS" and "DTS Digital Surround" are trademarks of Digital Theater Systems, Inc. ©1996 Digital Theater Systems, Inc. All rights reserved.

# DSP/EQ Function

## To Select a DSP/EQ

Press the DSP/EQ Mode button.

- Press **DSP/EQ** on the front panel or **DSP/EQ** on the remote control until the required option is selected. Each time the **DSP/EQ** button is pressed in sequence, the equalizer and sound modes "PASS, POP, ROCK, CLASSIC, CINEMA, HALL, LIVE CLUB, DISCO" are selected in this order.

What is a DSP/EQ?

DSP/EQ synthetically recreates the sound field to achieve a more realistic, powerful sound.

**Note**

- DSP/EQ mode cannot be selected when a microphone is connected.
- When playing a DVD encoded in two or more channels, DSP/EQ mode cannot be selected.

# Power Sound Function

## Power Sound Function

Press the Power Sound button.

- **P. SND ON, P. SND OFF** are displayed for a few seconds.

What is a Power Sound?

This system is equipped with the Power Sound feature, which makes the sound more powerful and full-bodied.

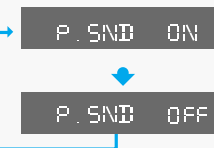

**Note**

- When playing a DVD encoded in two or more channels, Power Sound function cannot be selected.

# Listening to the Radio

You can listen to the chosen band (FM, AM broadcast stations) by using either the automatic or manual tuning operation.

GB

Remote Control Unit

1

Press the **Tuner(Band)** button.

- The selection toggles back and forth between "FM" and "AM" each time the **Tuner(Band)** button is pressed.

2

Select a broadcast station.

**Auto Station 1** When the **◀▶** button is pressed, a preset broadcast station is selected.

**Auto Station 2** Hold in the **◀▶** button. Automatic searching begins, and then stops when a station is tuned in.

**Manual Station** Press the **◀▶** button to tune to the chosen station. The frequency changes incrementally in either direction each time the corresponding button is pressed.

Main Unit

1

Press the **Function** button to select the desired band (FM, AM).

2

Select a broadcast station.

**Auto Station 1** Press the **Stop (■)** button to select the PRESET mode. Then press the **◀▶** button to select a station stored in the preset. See the instructions on the next page to preset stations.

**Auto Station 2** Press the **Stop (■)** button to select the MANUAL mode on the front panel. Then hold in the **◀▶** button to make the unit begin automatically searching for broadcast stations.

**Manual Station** Press the **Stop (■)** button to select the MANUAL mode on the front panel. Press the **◀▶** button to tune to the desired station. The frequency changes incrementally in either direction each time the corresponding button is pressed.

## To Listen in Mono/Stereo



Press the **MO/ST** button. (FM only)

- The selection toggles back and forth between "STEREO" and "MONO" each time the **MO/ST** button is pressed.
- In a poor reception areas, select Mono mode for a clear, interference-free broadcast.

# Presetting stations

You can store up to:

- ◆ 15 FM stations
- ◆ 15 AM stations
- **FM** ..... Frequency Modulation
- **AM(MW)** ..... Medium Wave

GB

Example: Presetting FM 89.1 in the memory

1

Press the **Tuner(Band)** button and select the FM band.

2

Select **MANUAL** by pressing the **Stop (■)** button on the main unit.

3

Use the **◀** and **▶** button to tune to 89.1

- The selection toggles back and forth between "FM" and "AM" each time the **Tuner(Band)** button is pressed.



4

Press the **Program** button on the remote control, FM1 will flash. If you want to save 89.1 to FM1, press Program again.

5

If you want to save 89.1 to another preset location (FM2-FM15), press **◀** or **▶**, then press **Program** to save it to that location.

6

To preset other stations, follow steps 1~4 again.



## To store other Channels

- Follow steps 3-5 again.

## To tune in a preset station

- See the previous page.

# Sleep Function

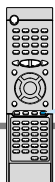

## To set up Sleep

### Press the Sleep button.

- Each time the button is pressed the selection toggles as follows: SLEEP 10 → SLEEP 20 → SLEEP 30 → SLEEP 60 → SLEEP 90 → SLEEP 120 → SLEEP 150 → OFF.

What is the Sleep function?

You can set the sleep time so that the unit powers off automatically after a preset period of time.

## To Review Sleep Setting

- The remaining time for the selected Sleep time is displayed.
- Pressing the button once again changes the Sleep time from the last setting.

# Troubleshooting

Problem	Check
<b>The disc tray does not open.</b>	<ul style="list-style-type: none"> <li>• Is the disc installed with the label side facing up?</li> <li>• Is the power cord plugged securely into the power outlet?</li> <li>• Turn off the power to the unit by pressing the <b>Power</b> (⏻) button and turn it back on.</li> </ul>
<b>Disc does not play.</b>	<ul style="list-style-type: none"> <li>• Check the region number of the DVD.</li> <li>• DVD discs purchased abroad may not be playable.</li> <li>• This player cannot play CD-ROMs, DVD-ROMs, etc.</li> <li>• Check the rating level of the DVD.</li> </ul>
<b>Playback does not start immediately when the Play/Pause button is pressed.</b>	<ul style="list-style-type: none"> <li>• Check whether the disc has any scratch marks or is deformed.</li> </ul>
<b>No sound is produced.</b>	<ul style="list-style-type: none"> <li>• No sound is heard during high-speed playback, slow playback, and step motion playback modes.</li> <li>• Are the speakers properly connected? Is the speaker Setup correctly customized?</li> <li>• Is the disc severely damaged? The disc may be dirty. Wipe off fingerprints or dirt.</li> </ul>
<b>Sound can be heard only from a few speakers and not all six.</b>	<ul style="list-style-type: none"> <li>• When listening to a CD or radio, sound is output to the front speakers only (L/R). Select the "PRO LOGIC" option by pressing the Pro Logic button on the remote control unit to use all six speakers.</li> <li>• Check whether your DVD disc is 5.1 CH compatible.</li> </ul>
<b>Picture does not appear; sound is not produced; the disc tray opens 2-5 seconds later.</b>	<ul style="list-style-type: none"> <li>• Was the player moved suddenly from a cold place to a warm one? When condensation forms inside the player, remove the disc and let the player stand for 1 or 2 hours with the power on. (You can use the player after the condensation disappears.)</li> </ul>
<b>Sound quality is irregular.</b>	<ul style="list-style-type: none"> <li>• Are the speaker cables loose?</li> <li>• Is there any dirt or debris at the end of the speaker connector?</li> </ul>
<b>Dolby Digital 5.1 Channel Surround Sound is not being reproduced.</b>	<ul style="list-style-type: none"> <li>• Does the disc being played show the "Dolby Digital 5.1CH" mark? 5.1-channel sound is reproduced only if the disc is recorded with 5.1 channel sound.</li> <li>• Is the DVD player connected to the proper speakers?</li> </ul>



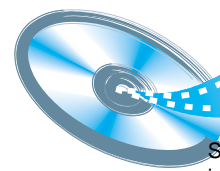

## Cautions on Handling and Storing Discs

Small scratches on the disc may reduce sound and picture quality or cause breaks in playback. Be especially careful not to scratch discs when handling them.

Problem	Check
<ul style="list-style-type: none"> <li>• The disc revolves but no picture appears.</li> <li>• Picture shows interference and quality is poor.</li> </ul>	<ul style="list-style-type: none"> <li>• Is the TV power turned on?</li> <li>• Are the video cables properly connected?</li> <li>• Is it the player in PAUSE mode?</li> <li>• Is there any dirt on the disc, or is the disc damaged?</li> <li>• It may not be possible to play some DVD discs due to poor manufacture.</li> <li>• When a dark scene changes to a bright scene during playback, the screen may flicker vertically. Some disturbance is normal.</li> </ul>
Remote control unit does not operate.	<ul style="list-style-type: none"> <li>• Is the remote control being used within the appropriate distance and angle of operation for the unit?</li> <li>• Are there any obstacles between the remote control unit and the remote control sensor?</li> <li>• Are the batteries dead? Is it time to replace the batteries with new ones?</li> </ul>
Audio or subtitle language does not operate.	<ul style="list-style-type: none"> <li>• The audio or subtitle language features does not operate with DVDs that do not include multiple audio or subtitle languages.</li> </ul>
The Menu button is pressed but the Menu screen does not appear.	<ul style="list-style-type: none"> <li>• Is the remote control being used within the appropriate distance and angle of operation for the unit?</li> <li>• Are the batteries dead?</li> <li>• Does the disc have a Menu?</li> </ul>
The screen ratio cannot be changed.	<ul style="list-style-type: none"> <li>• You can play 16:9 wide DVDs in 16:9 WIDE mode or 4:3 LETTER BOX mode or 4:3 PAN-SCAN mode; but 4:3 encoded DVDs only show in 4:3 ratio. Refer to the DVD disc jacket and then select the appropriate function.</li> </ul>
The desired radio station cannot be tuned in.	<ul style="list-style-type: none"> <li>• Is the antenna installed properly?</li> <li>• When the antenna's input signal is weak, install an external FM antenna in an area with good reception quality.</li> </ul>
The system is malfunctioning (the system does not work or no sound).	<ul style="list-style-type: none"> <li>• While the player is in the stop mode, hold the Stop (■) button down on the main unit for over 5 seconds. "INITIAL" appears on the display and all settings will return to the Factory Preset condition. <b>The RESET function erases all settings; do not use this function unless necessary.</b></li> </ul>

### Handling and Storing Discs



**When you get fingerprints or dirt on the disc, clean it with a mild detergent diluted in water and wipe with a soft cloth.**

- When cleaning, wipe gently from the inside to the outside of the disc.

#### Note

Condensation may form if warm air comes into contact with cold parts inside the player. When condensation forms inside the player, the player may not operate correctly. If this occurs, remove the disc and let the player stand for 1 or 2 hours with the power on.

### Disc Storage

**Do not keep in direct sunlight**

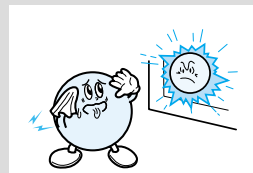

**Keep in a cool ventilated area**

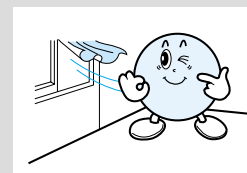

**Keep in a clean Protection jacket. Store vertically.**

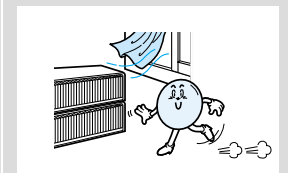



- Do not allow the discs to become contaminated with dirt.
- Do not load cracked discs or discs that are scratched.



# Disc Type and Protection

GB

## Usable Discs

Disc Types	Marks	Recording Types	Disc Size	Max. Playing Time		
DVD		Audio + Video	12cm	Approx. 240 min. (Single-sided) Approx. 480 min. (Double-sided)		
			8cm	Approx. 160 min. (Single-sided) Approx. 160 min. (Double-sided)		
			VIDEO-CD		12cm	74 min.
			8cm		20 min.	
AUDIO-CD		Audio	12cm	74 min.		
			8cm	20 min.		



Dolby Digital disc



DTS Disc



Digital Audio disc



Stereo disc



NTSC broadcast system in USA, Canada, Japan, South Korea, etc..



MP3 disc

# Specifications

GB

GENERAL	Power Consumption	95W	
	Weight	5.8Kg	
	Dimensions	350(W) x 80(H) x 350(D) mm	
	Operating Temperature Range	+5°C ~ +35°C	
	Operating Humidity Range	10% ~ 75%	
FM	Usable Sensitivity	10dB	
	S/N Ratio	60dB	
	Distortion	0.5%	
AM	Usable Sensitivity	54dB	
	S/N Ratio	40dB	
	Distortion	2%	
VIDEO OUTPUT	Composite Video	1.0Vp-p(75Ω load)	
	Component Video	Y:1.0Vp-p(75Ω load)	
		Pr:0.70Vp-p(75Ω load)	
		Pb:0.70Vp-p(75Ω load)	
	S-VIDEO	Luminance Signal: 1.0Vp-p(75Ω load) Color Signal: 0.286Vp-p(75Ω load)	
AMPLIFIER	Front speaker output	28W x 2(6Ω)	
	Center speaker output	28W(6Ω)	
	Rear speaker output	28W x 2(6Ω)	
	Subwoofer speaker output	45W(3Ω)	
	Frequency range	20Hz~25KHz	
	S/N Ratio	75dB	
	Channel separation	50dB	
	Input sensitivity	(AUX)500mV	
SPEAKER	Speaker system	5.1 ch speaker system	
		Front/Center/Rear speaker	Subwoofer speaker
	Impedance	6Ω x 5	3Ω
	Frequency range	150Hz~18KHz	45Hz~200Hz
	Output sound pressure level	87dB/W/M	86dB/W/M
	Rated input	28W	45W
	Maximum input	56W	90W
	Dimensions	98(W) x 110(H) x 110(D) mm	200(W) x 332(H) x 300(D) mm
Weights	0.6Kg	3.9Kg	

